

# PRODUCT DATA SHEET

2024-04-09



Article number:

4005006401TGEE

Braked castor 50 mm, wheel brake, TPU-tyre

Swivel bracket with wheel brake. Made of zinc-chromatized pressed sheet metal with double ball race swivel. Center hole fitting. Grey laquered. Riveted wheel axle. Inline wheel with transparent TPU-tyre. Hub made of grey polycarbonate. Plain bearing.



Image may differ from the actual product.\*

## DIMENSIONS

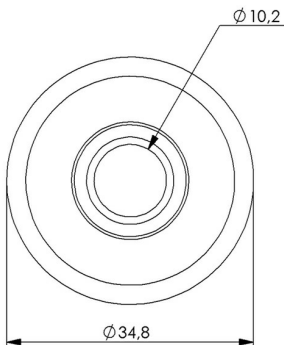

## SPECIFICATIONS

Diameter	50 mm
Totalt height	64 mm
Load Capacity (dynamic)	40 kg
Castor model	Brake
Fitting	Centre hole
Material Tread	Polyurethane
Bearing	Rivet
Thread hardness (Shore°)	98° Shore A
Centre Bolt Hole	10.2 mm
Brake	Wheel brake
Width of tread	20 mm
Hub Hole Diameter	6 mm
Material Hub	Polycarbonate (PC)
Wheel Pattern	EN 12530
Fork Width	22 mm
Painted Housing	Silver
Color Tread	Transparent
Teststandard	EN 12530
Offset	17.5 mm
Material Thickness Bracket	1.5 mm
Swivel radius	65 mm
Product Weight	0.11 kg
Temperature Range	-20°C to +50°C

Numeric values in the technical specification can be nominal/rounded to the nearest standard dimension. To see exact values, please use the drawing.