

PRODUCT DATA SHEET

2024-04-11



Article number:

4005000401TGEV

Swivel castor 50 mm, TPU-tyre

Swivel bracket. Made of zinc-chromatized pressed sheet metal with double ball race swivel. Center hole fitting. White laquered. Riveted wheel axle. Inline wheel with transparent TPU-tyre. Hub made of grey polycarbonate. Plain bearing.



Image may differ from the actual product.*

DIMENSIONS

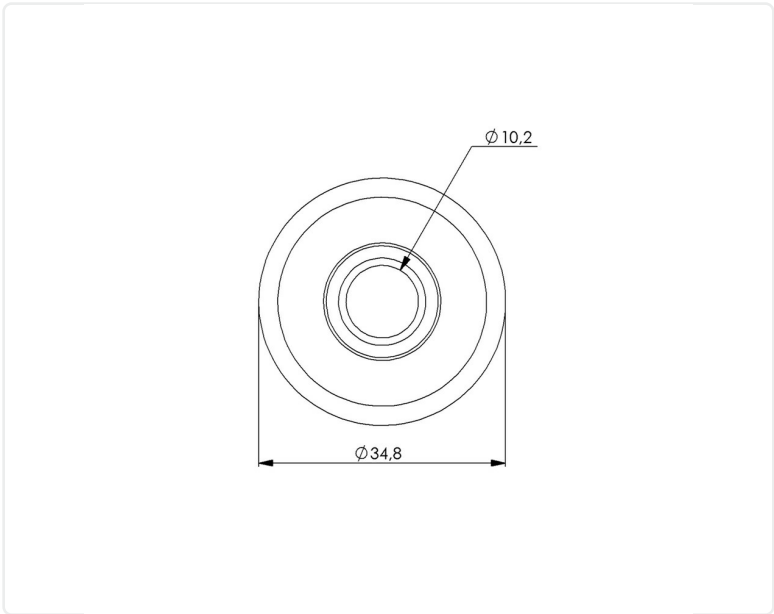

SPECIFICATIONS

Diameter	50 mm
Totalt height	64 mm
Load Capacity (dynamic)	40 kg
Castor model	Swivel
Fitting	Centre hole
Material Tread	Polyurethane
Bearing	Rivet
Thread hardness (Shore°)	98° Shore A
Centre Bolt Hole	10.2 mm
Width of tread	20 mm
Material Hub	Polycarbonate (PC)
ESD	No
Stainless	No
Wheels	No
Heat Resistant	No
Painted Housing	White
Fixed	No
Color Tread	Transparent
Material Type	RoHS (EU) - Approved
Offset	17,5 mm
Material Thickness Bracket	1,5 mm
Swivel radius	42,5 mm
Product Weight	0,09 kg
Temperature Range	-20°C to +50°C

Numeric values in the technical specification can be nominal/rounded to the nearest standard dimension. To see exact values, please use the drawing.