

PRODUCT DATA SHEET

2024-04-10



Article number:

4005006601GS 

Braked castor 50 mm, wheel brake, TPE-tyre

Swivel bracket with wheel brake. Made of zinc-chromatized pressed sheet metal with double ball race swivel. Center hole fitting. Riveted wheel axle. Wheel with grey TPE-tyre. Hub made of black PP. Plain bearing.



Image may differ from the actual product.*

DIMENSIONS

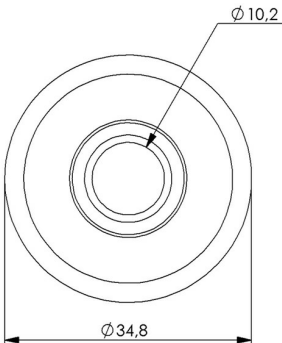

SPECIFICATIONS

Diameter	50 mm
Totalt height	64 mm
Load Capacity (dynamic)	40 kg
Castor model	Brake
Fitting	Centre hole
Material Tread	TPE
Bearing	Rivet
Thread hardness (Shore°)	85° Shore A
Centre Bolt Hole	10.2 mm
Brake	Wheel brake
Width of tread	20 mm
Material Hub	Polypropylen (pp)
Color Tread	Grey
Offset	17,5 mm
Material Thickness Bracket	1,5 mm
Swivel radius	65 mm

Numeric values in the technical specification can be nominal/rounded to the cneares standard dimension. To see exact values, please use the drawing.