

PRODUCT DATA SHEET

2024-04-11



Article number:

5110000713N

Swivel castor 100 mm, PP-wheel

Swivel bracket. Made of zinc-chromatized pressed sheet metal with double ball race swivel. Center hole fitting for M12 screw. Wheel axle with nut. Wheel made of nature PP. Plain bearing.



Image may differ from the actual product.*

DIMENSIONS

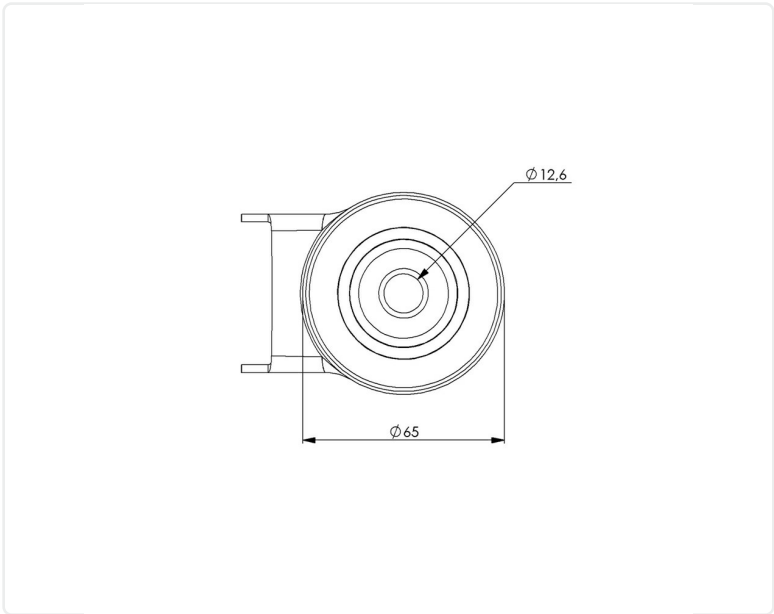

SPECIFICATIONS

Diameter	100 mm
Totalt height	132 mm
Load Capacity (dynamic)	140 kg
Castor model	Swivel
Fitting	Centre hole
Material Tread	Polypropylene (PP)
Bearing	Plain bearing
Thread hardness (Shore°)	65° Shore D
Centre Bolt Hole	12.4 mm
Width of tread	36 mm
Material Hub	Polypropylen (pp)
Color Tread	Nature
Material Type	RoHS (EU) - Approved
Offset	40 mm
Material Thickness Bracket	2,5 mm
Product Weight	0,51 kg
Temperature Range	-30°C to +70°C

Numeric values in the technical specification can be nominal/rounded to the cneares standard dimension. To see exact values, please use the drawing.